

## PROMASEAL®-A Spray Fire stopping coating Product handling guideline

Joint

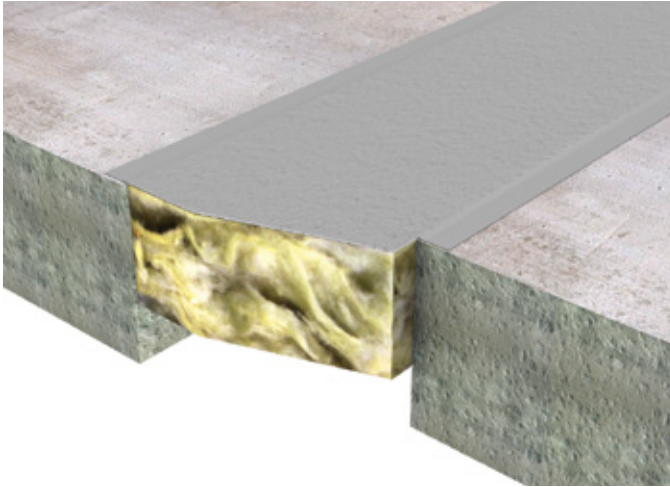

### PROMASEAL®-A Spray Fire stopping coating



#### Coating on mineral wool

Product	Dry-film thickness	Wet-film thickness	Consumption
PROMASEAL®-A Spray	1 mm	1,4 mm	1,90 kg/m <sup>2</sup>

PROMASEAL®-A Spray is an acrylic based, single component fire stopping sealant. It forms a flexible seal once dry, is very suitable for accommodating movement and is also resistant to moisture.

#### General information

- Storage and transport temperature 3 °C - 35 °C;
- Stir PROMASEAL®-A Spray well (we recommend a mechanical mixer);
- PROMASEAL®-A Spray can be diluted (maximum 0,5 litre clean water per 12 kg bucket);
- PROMASEAL®-A spray can be applied with a brush, roller, spatula or airless device;
- Once opened containers should be fully used as soon as possible. Reseal containers properly after use;
- Drying time: approx. 8 hours at 20 °C and a relative humidity of 65 % for 1 mm;
- Clean tools with water after use;
- 1 mm dry-film thickness is equivalent to 1,4 mm wet-film thickness (approx. 1900 g/m<sup>2</sup>);
- Overpainting is possible; adhesion and compatibility must be checked.
- Minimum +5 °C, maximum +40 °C for both substrate and ambient temperature;
- Substrate must be free of oil, grease and dust;
- Use water to dampen or water-diluted PROMASEAL®-A Spray and act as a primer for absorbant substrates.

#### System installation details

Please refer to ETA, classification report or handbook for installation details on joints.

#### Safety information

Safety data sheet available on request.

### 1. Installation guideline static joint

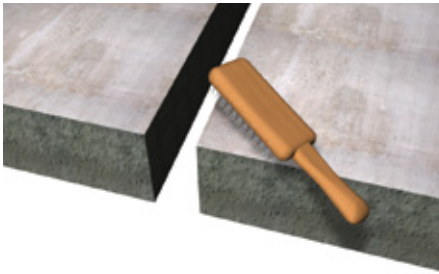

1. Clean aperture opening

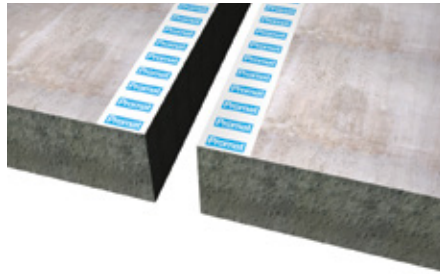

2. If required, mask out the working area on the wall/floor with tape



3. Compress mineral wool (melting point 1000 °C, class A1, density  $\geq 40 \text{ kg/m}^3$ ) 30 % and insert in joint

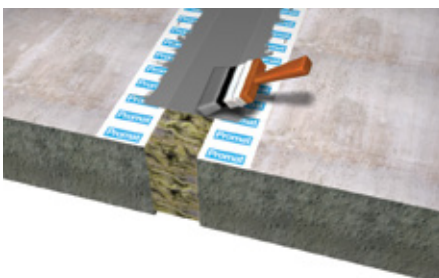

4. Apply correct thickness of PROMASEAL®-A Spray to mineral wool

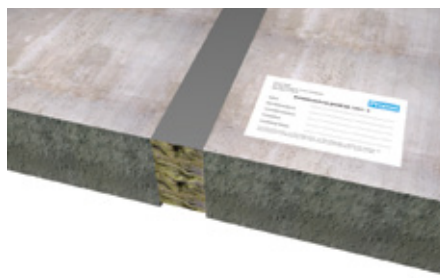

5. Fix identification label.

### 2. Installation guideline dynamic joint (floor only)

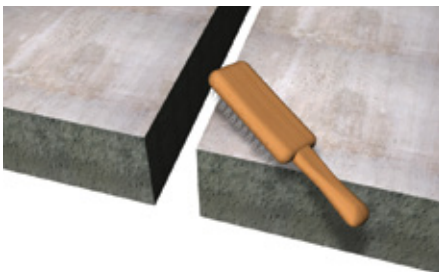

1. Clean aperture opening and dampen with water if required



2. Coat the aperture opening

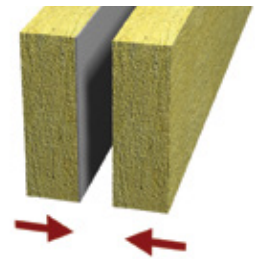

3. Coat the surface of the mineral wool boards

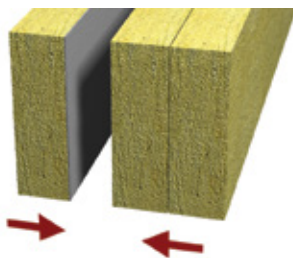

4. Depending on joint width use correct amount of mineral wool boards

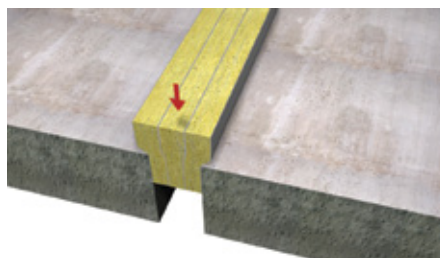

5. Compress mineral wool (melting point 1000 °C, class A1, density  $\geq 40 \text{ kg/m}^3$ ) 30 % and insert in the joint

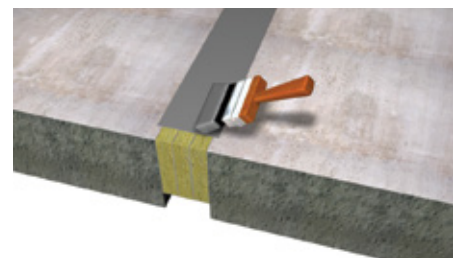

6. Apply correct thickness of PROMASEAL®-A Spray onto the mineral wool on both sides of the floor with 5 mm overlapping to the substrate

The products must be applied in accordance with regulations for construction material in general and fire stopping in particular, with the applicable national test certificates and approvals and in accordance with applicable national building regulations. Products may only be applied by trained professionals with adequate knowledge and only after thorough review of the installation guidelines, safety data sheets, national test certificates and approvals. For additional information on how and where to use this product please refer to the Promat handbook or contact your local Promat office. All the relevant documents can be obtained free of charge from the local Promat office. For Non European Union countries separate guidelines are relevant. If required please contact us.

## **Bulgaria**

### **Etex Building Performance S.A.**

Str. Vulturilor Nr. 98, 5th Floor  
030857 Bucharest, Romania  
M +359 878 81 51 05  
E [info.bg@promat-see.com](mailto:info.bg@promat-see.com)  
[www.promat-see.com](http://www.promat-see.com)

## **Croatia, Bosnia and Herzegovina**

### **Etex Building Performance**

#### **Promat d.o.o.**

Kovinska 4a  
10090 Zagreb  
T +385 1 349 63 24  
F +385 1 379 41 54  
E [info.hr@promat-see.com](mailto:info.hr@promat-see.com)  
[www.promat-see.com](http://www.promat-see.com)

## **Greece**

### **Etex Building Performance S.A.**

Str. Vulturilor Nr. 98, 5th Floor  
030857 Bucharest, Romania  
T +40 31 224 01 00  
F +40 31 224 01 01  
E [info@promat-see.com](mailto:info@promat-see.com)  
[www.promat-see.com](http://www.promat-see.com)

## **Hungary**

### **Etex Building Performance**

#### **Creaton South-East Europe Kft.**

Malomkő u. 7.1. emelet  
2040 Budaörs  
M +36 30 343 2572  
M +36 30 455 1273  
E [info.hu@promat-see.com](mailto:info.hu@promat-see.com)  
[www.promat-see.com](http://www.promat-see.com)

## **Kosovo, Albania**

### **Etex Building Performance Sh.A.**

Ulpiana, D-1, HY-4 Nr.2  
10000 Prishtina  
T +383 38 553 407  
M +381 64 61 39 763  
M +377 44 120 671  
E [info@promat-see.com](mailto:info@promat-see.com)  
[www.promat-see.com](http://www.promat-see.com)

## **Romania**

### **Etex Building Performance S.A.**

Str. Vulturilor Nr. 98, 5th Floor  
030857 Bucharest  
T +40 31 224 01 00  
F +40 31 224 01 01  
E [info.ro@promat-see.com](mailto:info.ro@promat-see.com)  
[www.promat-see.com](http://www.promat-see.com)

## **Serbia, Macedonia, Montenegro**

### **Etex Building Performance d.o.o.**

Vojvode Putnika 79  
21208 Sremska Kamenica  
T +381 21 210 10 90  
M +381 63 625 426  
M +381 63 510 720  
E [info.rs@promat-see.com](mailto:info.rs@promat-see.com)  
[www.promat-see.com](http://www.promat-see.com)

## **Slovakia**

### **Etex Building Performance**

#### **EBM Co. s.r.o.**

Štúrova 155  
949 01 Nitra  
M +421 915 936 126  
E [info.sk@promat-see.com](mailto:info.sk@promat-see.com)  
[www.promat-see.com](http://www.promat-see.com)

## **Slovenia**

### **Etex Building Performance**

#### **Promat d.o.o.**

Kidričeva 56b  
4220 Škofja Loka  
T +386 4 51 51 451  
F +385 4 51 51 450  
E [info.si@promat-see.com](mailto:info.si@promat-see.com)  
[www.promat-see.com](http://www.promat-see.com)