

Promat

PROMASEAL®-A Fire stopping acrylic

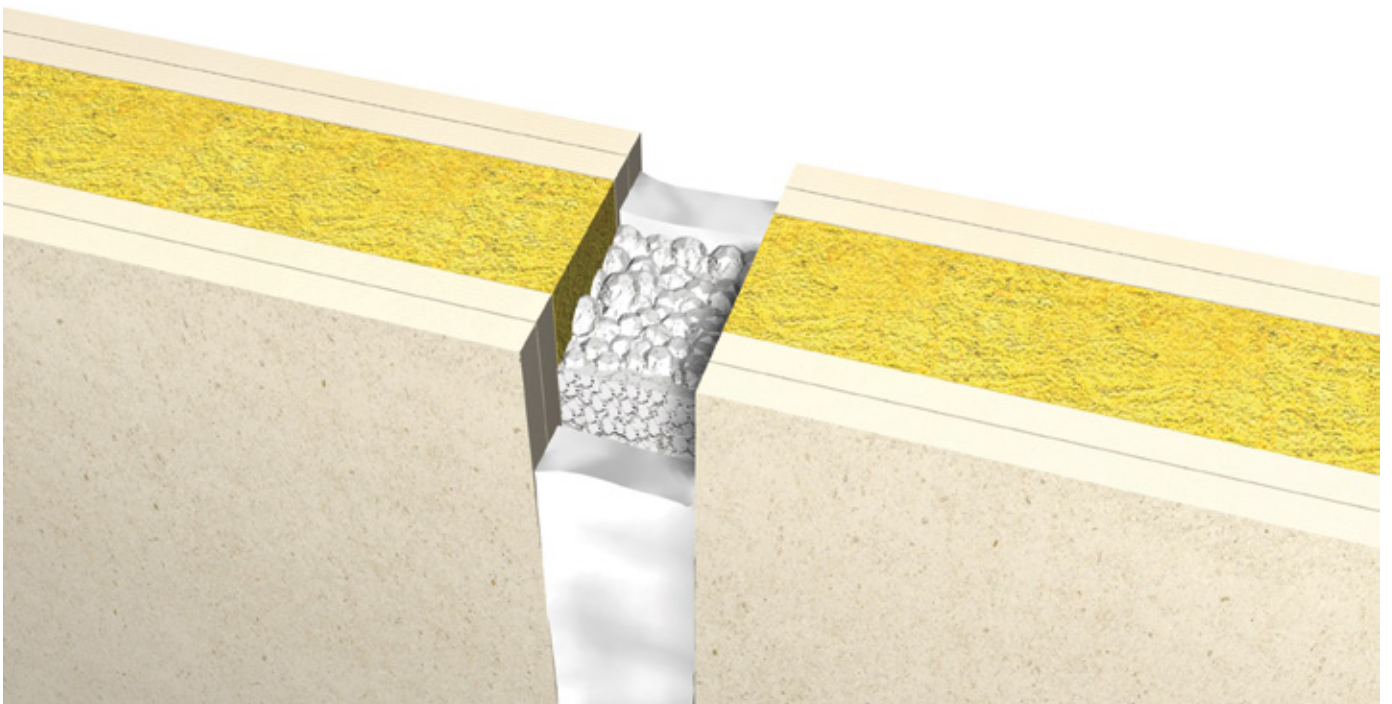

www.promat-see.com





General description

PROMASEAL®-A is an acrylic-based, single component fire stopping sealant. Joints without movement can be sealed quickly and securely thanks to its outstanding application qualities. A common emulsion paint can be used to colour the joints.

Fields of application

PROMASEAL®-A is a fire stopping sealant for joints in walls and floors with a maximum movement of 7,5 %.

PROMASEAL®-A can also be used as an annular clearance seal between structural components and sustained insulation.

System advantages / customer benefit

- Can be painted
- Good adhesion to various substrates

Test certificate / approval

- EN 1366-3/4
- EN 13501-1/2
- ETAG 026-2/3

Packaging

- 310 ml cartridges
- 12 cartridges/box
- 1248 cartridges/pallet

Subject to change.

Storage requirements

- Store in cool and dry conditions: 3 °C - 35 °C
- Shelf life of original sealed containers at least 12 months
- Once opened, containers should be finished swiftly

Safety instructions

- Please refer to the safety data sheet for additional advice

Technical data and properties

Colour	white/grey
Consistency	paste
Density	wet : 1,6 ± 0,2 g/cm ³ dry : 1,8 ± 0,2 g/cm ³
Solid content	86 ± 5 wt%
Movement capabilities	elongation minimum 15 % compression minimum 15 %
Use category	Y ₁
Reaction to fire	E

Bulgaria

Etex Building Performance S.A.

Str. Vulturilor Nr. 98, 5th Floor
030857 Bucharest, Romania
M +359 878 81 51 05
E info.bg@promat-see.com
www.promat-see.com

Croatia, Bosnia and Herzegovina

Etex Building Performance

Promat d.o.o., Podružnica Zagreb

Kovinska 4a
10090 Zagreb
T +385 1 349 63 24
F +385 1 379 41 54
E info.hr@promat-see.com
www.promat-see.com

Greece

Etex Building Performance S.A.

Str. Vulturilor Nr. 98, 5th Floor
030857 Bucharest, Romania
T +40 31 224 01 00
F +40 31 224 01 01
E info@promat-see.com
www.promat-see.com

Hungary

Etex Building Performance

M +36 30 343 2572
M +36 30 455 1273
M: +36 30 541 8316
E info.hu@promat-see.com
www.promat-see.com

Kosovo, Albania

Etex Building Performance Sh.A.

Ulpiana, D-1, HY-4 Nr.2
10000 Prishtina
T +383 38 553 407
M +381 64 61 39 763
M +377 44 120 671
E info@promat-see.com
www.promat-see.com

Romania

Etex Building Performance S.A.

Str. Vulturilor Nr. 98, 5th Floor
030857 Bucharest
T +40 31 224 01 00
F +40 31 224 01 01
E info.ro@promat-see.com
www.promat-see.com

Serbia, Macedonia, Montenegro

Etex Building Performance d.o.o.

Vojvode Putnika 79
21208 Sremska Kamenica
T +381 21 210 10 90
M +381 63 625 426
M +381 63 510 720
E info.rs@promat-see.com
www.promat-see.com

Slovakia

Etex Building Performance

EBM Co. s.r.o.

Štúrova 155
949 01 Nitra
M +421 915 936 126
E info.sk@promat-see.com
www.promat-see.com

Slovenia

Etex Building Performance

Promat d.o.o.

Kidričeva 56b
4220 Škofja Loka
T +386 4 51 51 451
F +385 4 51 51 450
E info.si@promat-see.com
www.promat-see.com